

**FUNGI RACING**



KTM Swingarm Bearing Renewal Instructions

## Tools Required

Seal Remover

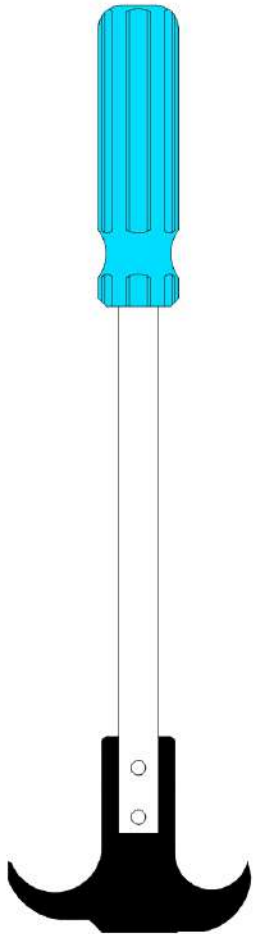

24mm Spanner  
or adjustable wrench

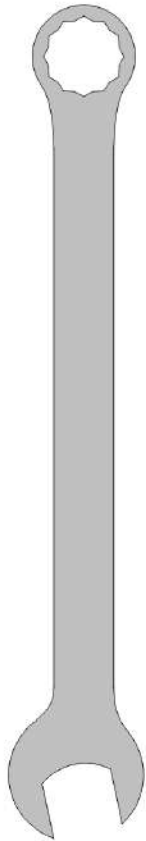

24mm Ratchet Spanner

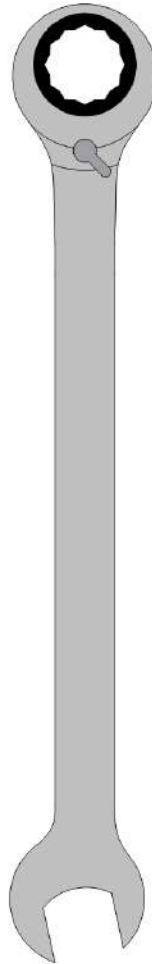

Magnet or magnetic  
pick up tool

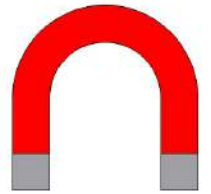

Begin replacing swingarm bearings  
from the left side of the swingarm  
(Chain side)  
(Chain guide can remain in place)

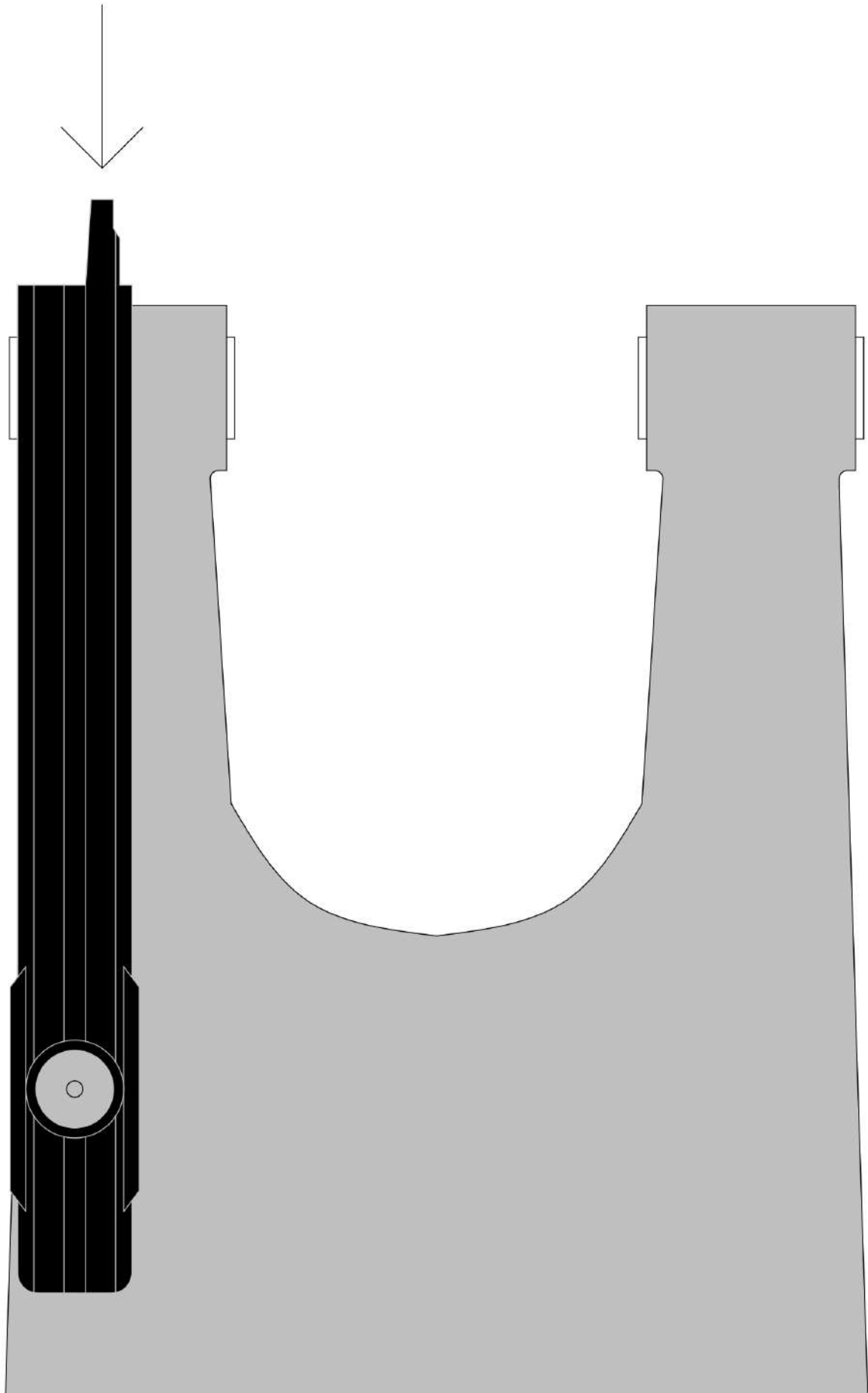

Remove bearing sleeve and seal buckets

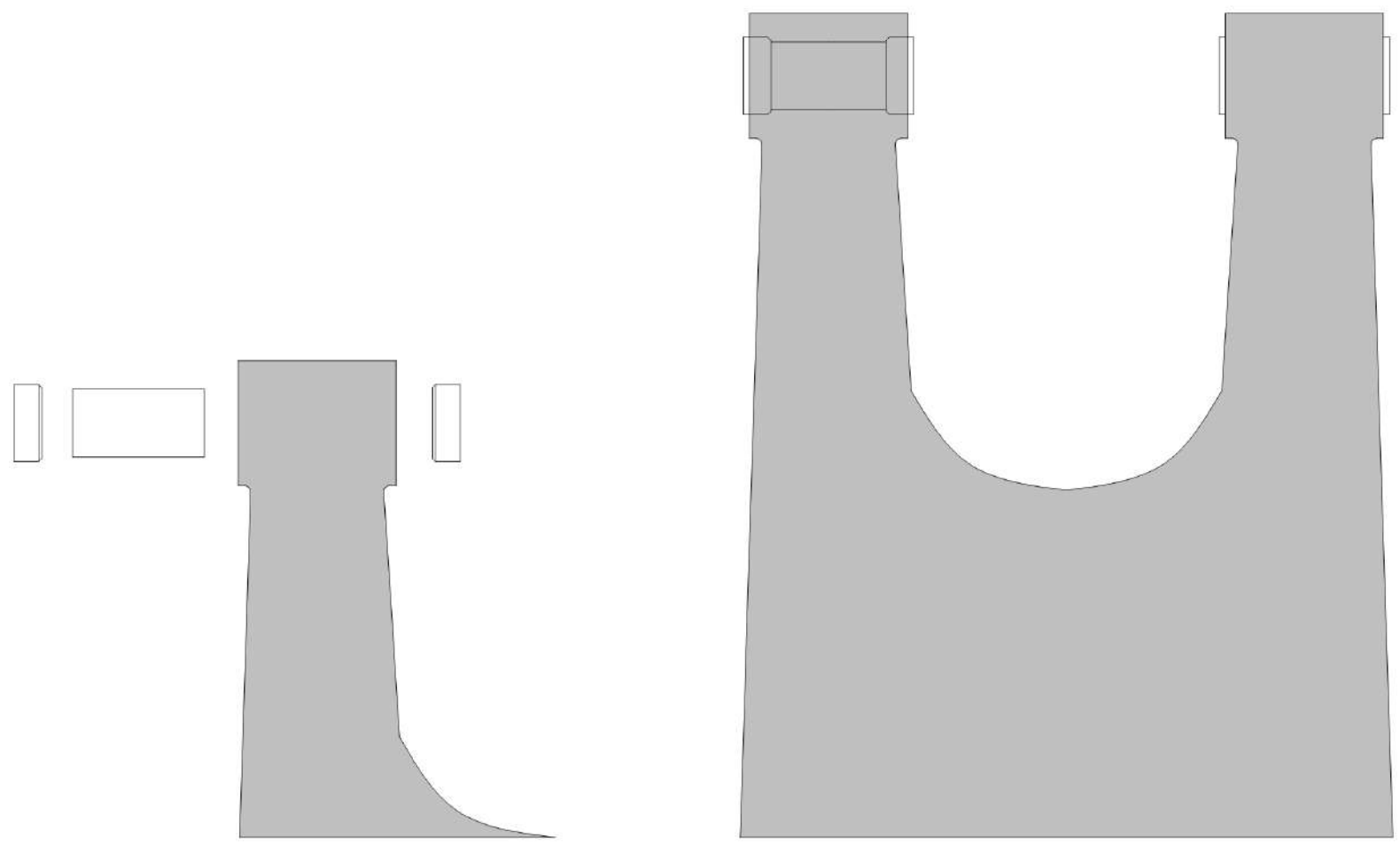

Remove both seals

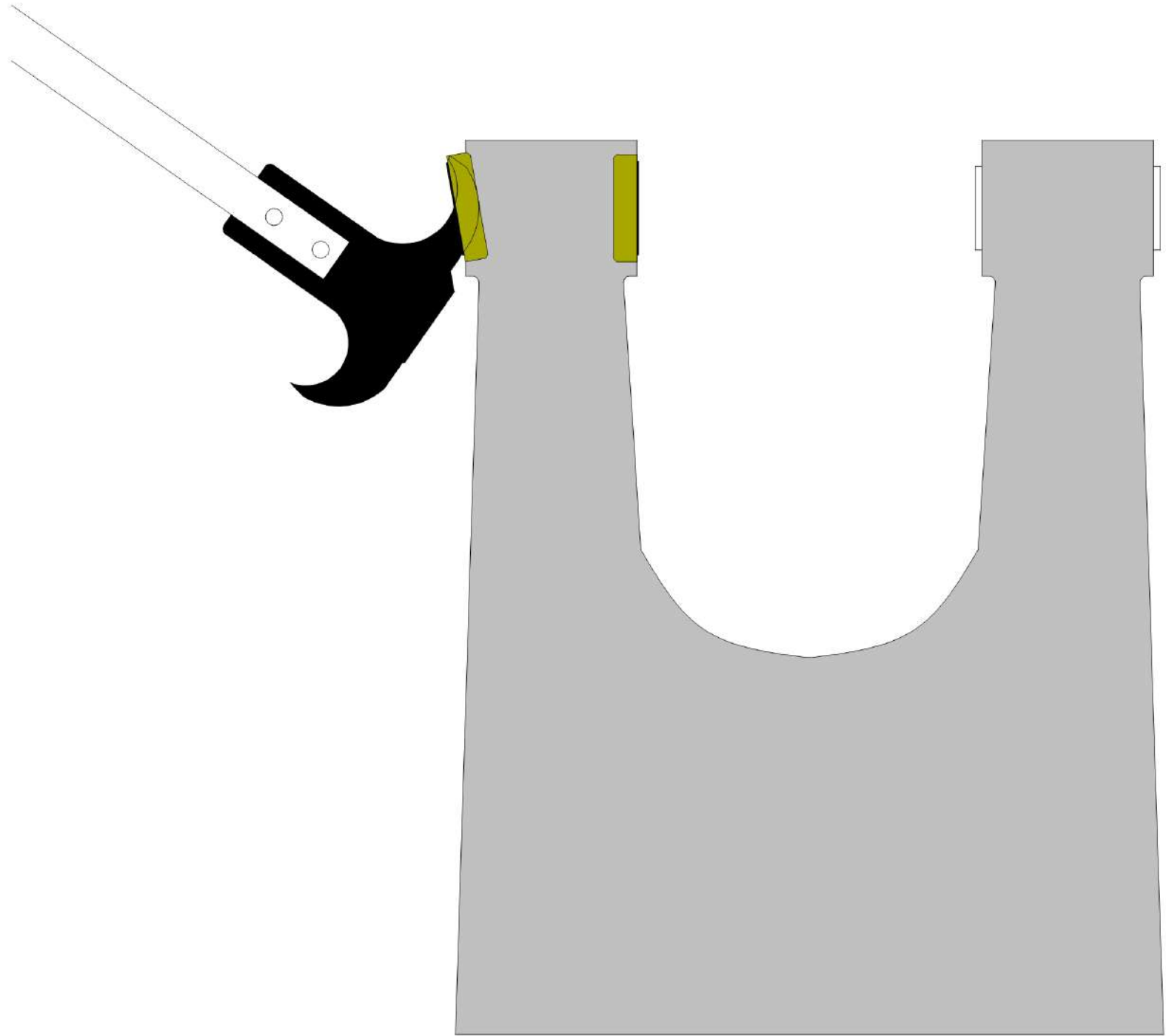

Use a magnet to remove both stop discs

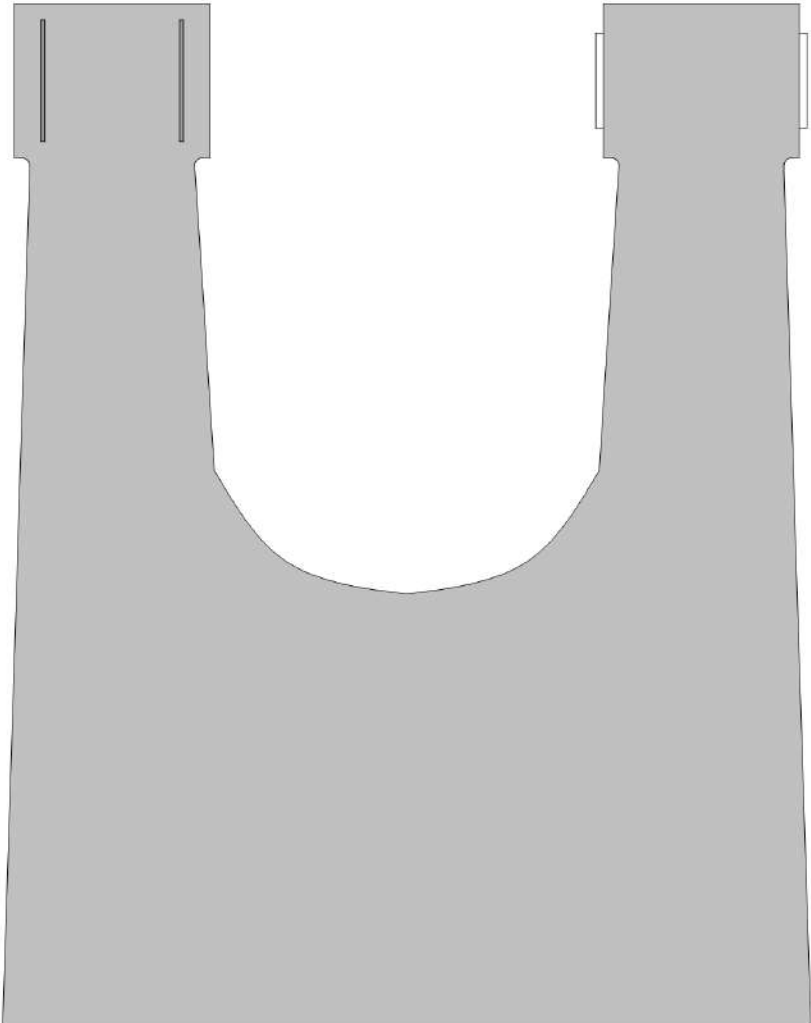
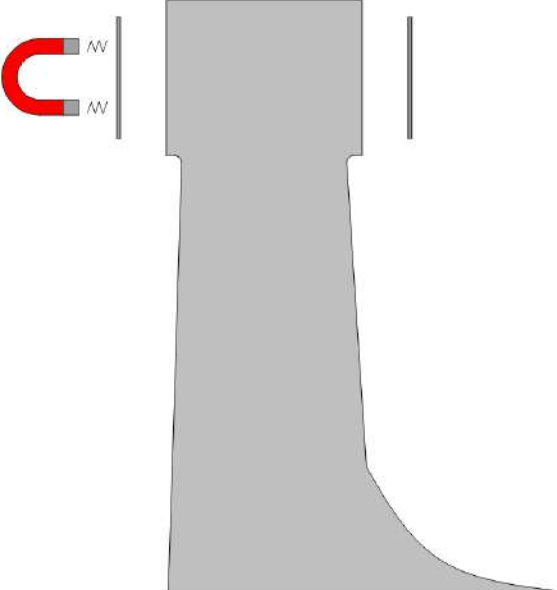

**Thoroughly oil thread  
(use engine oil)**

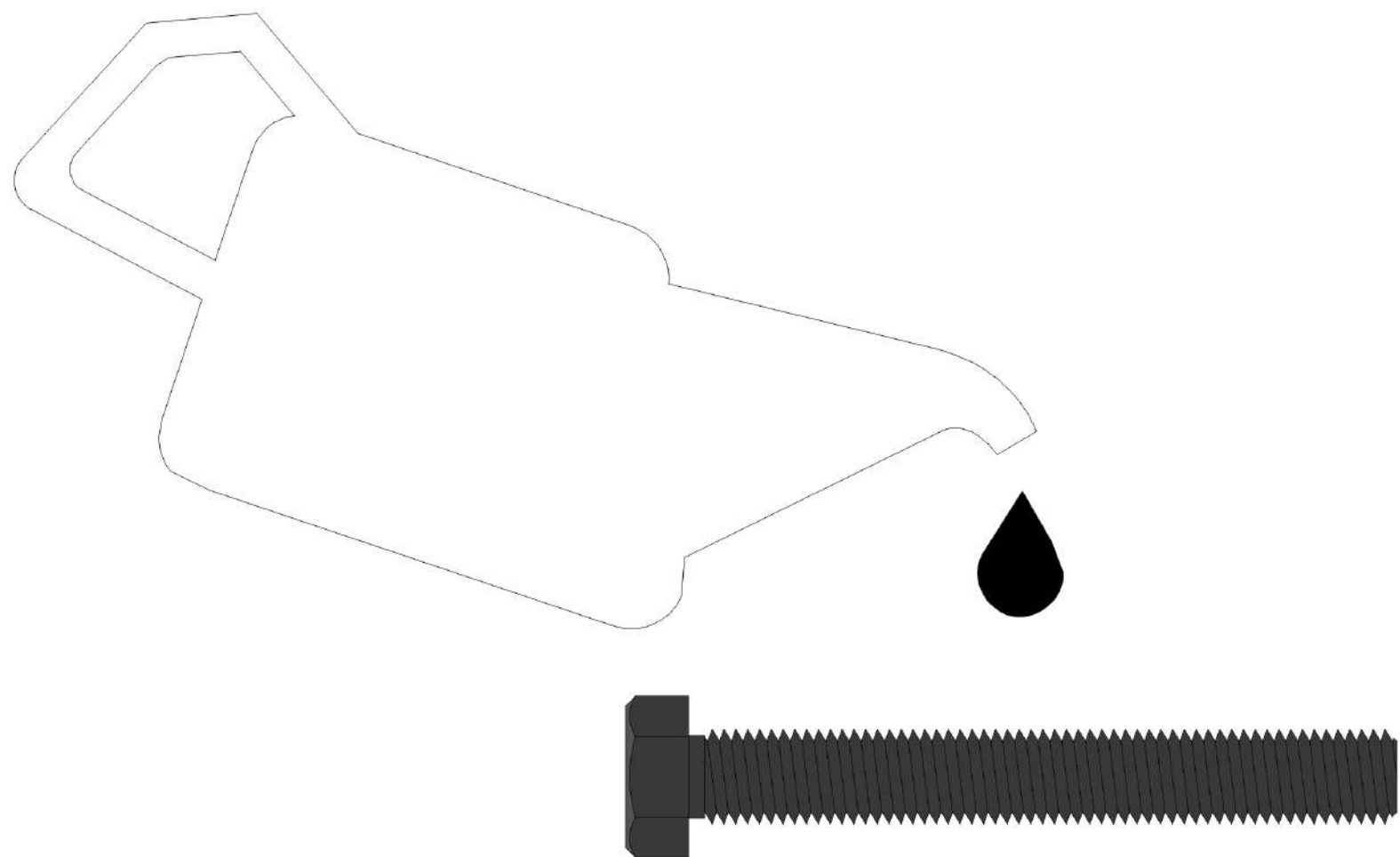

**Set up tool for bearing extraction  
(MAKE SURE STOP DISCS HAVE BEEN REMOVED)**

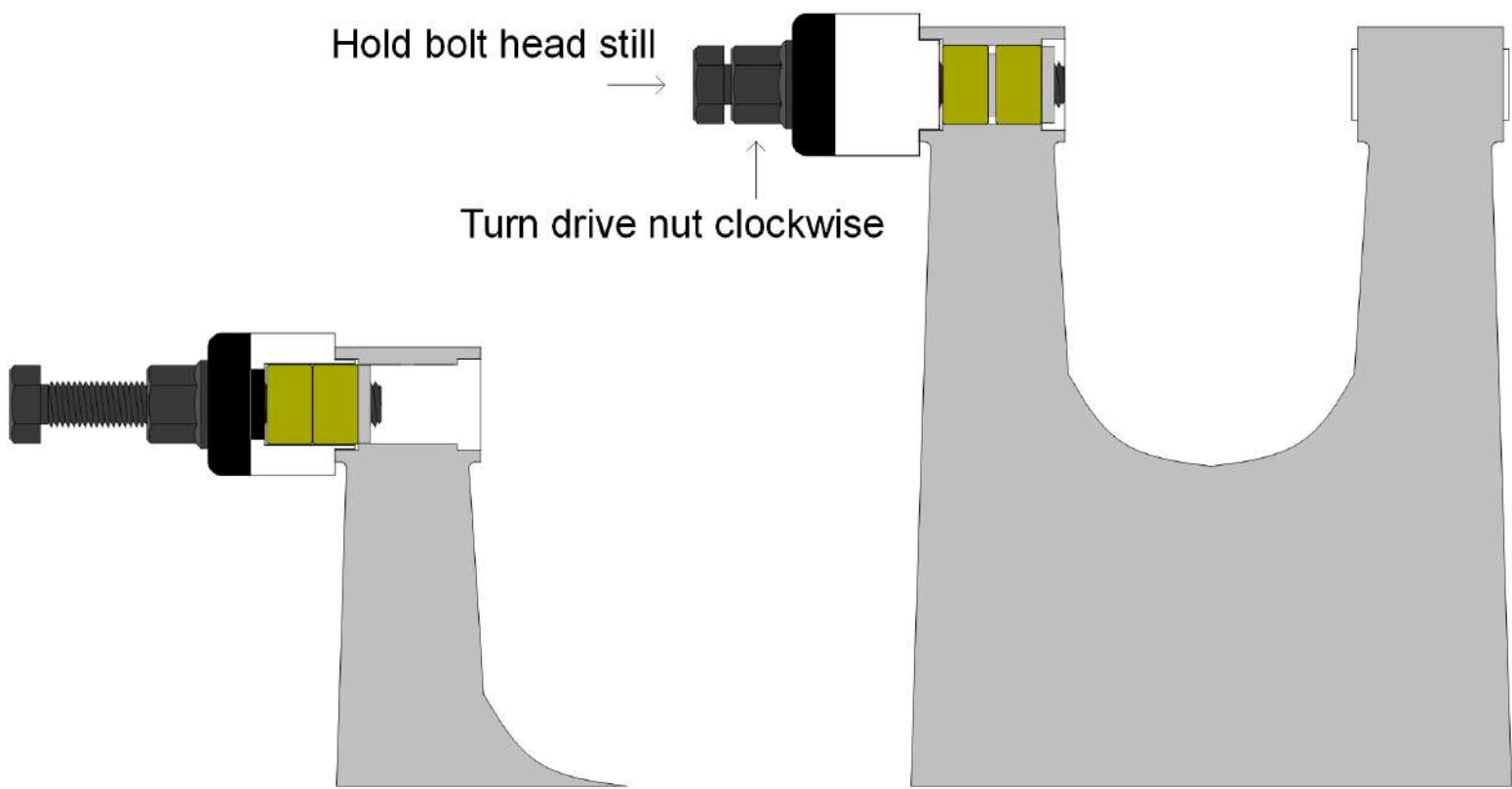
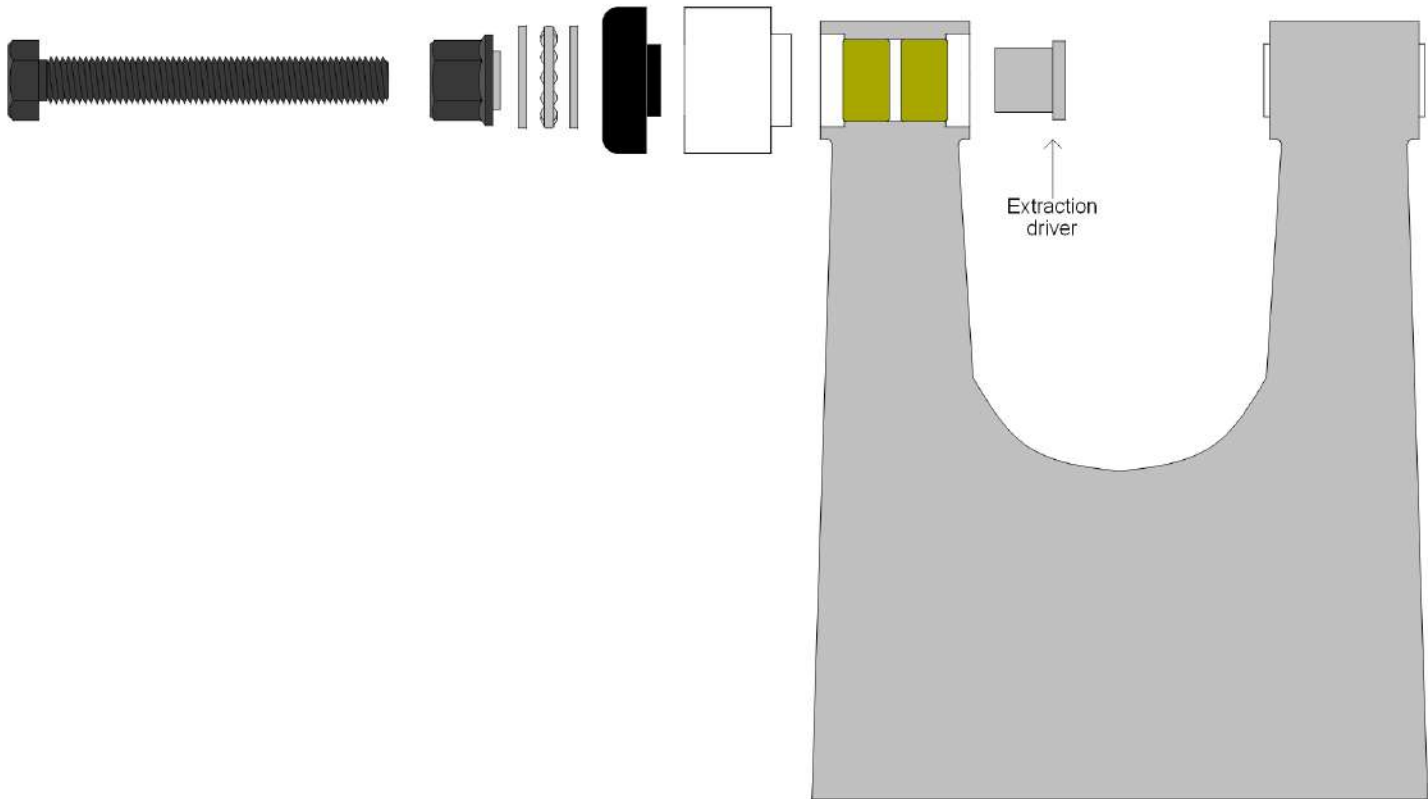



Set up tool for 1st bearing installation  
(Grease before installing)

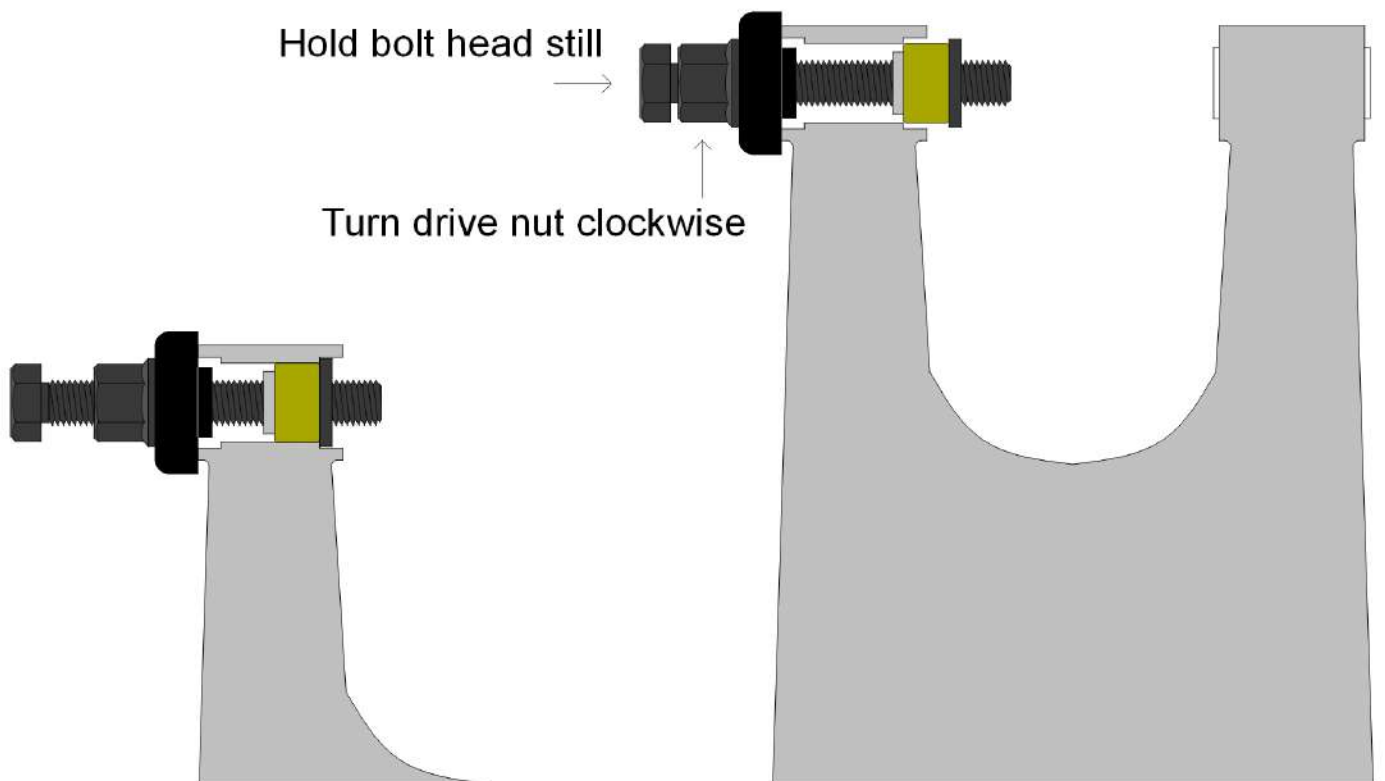
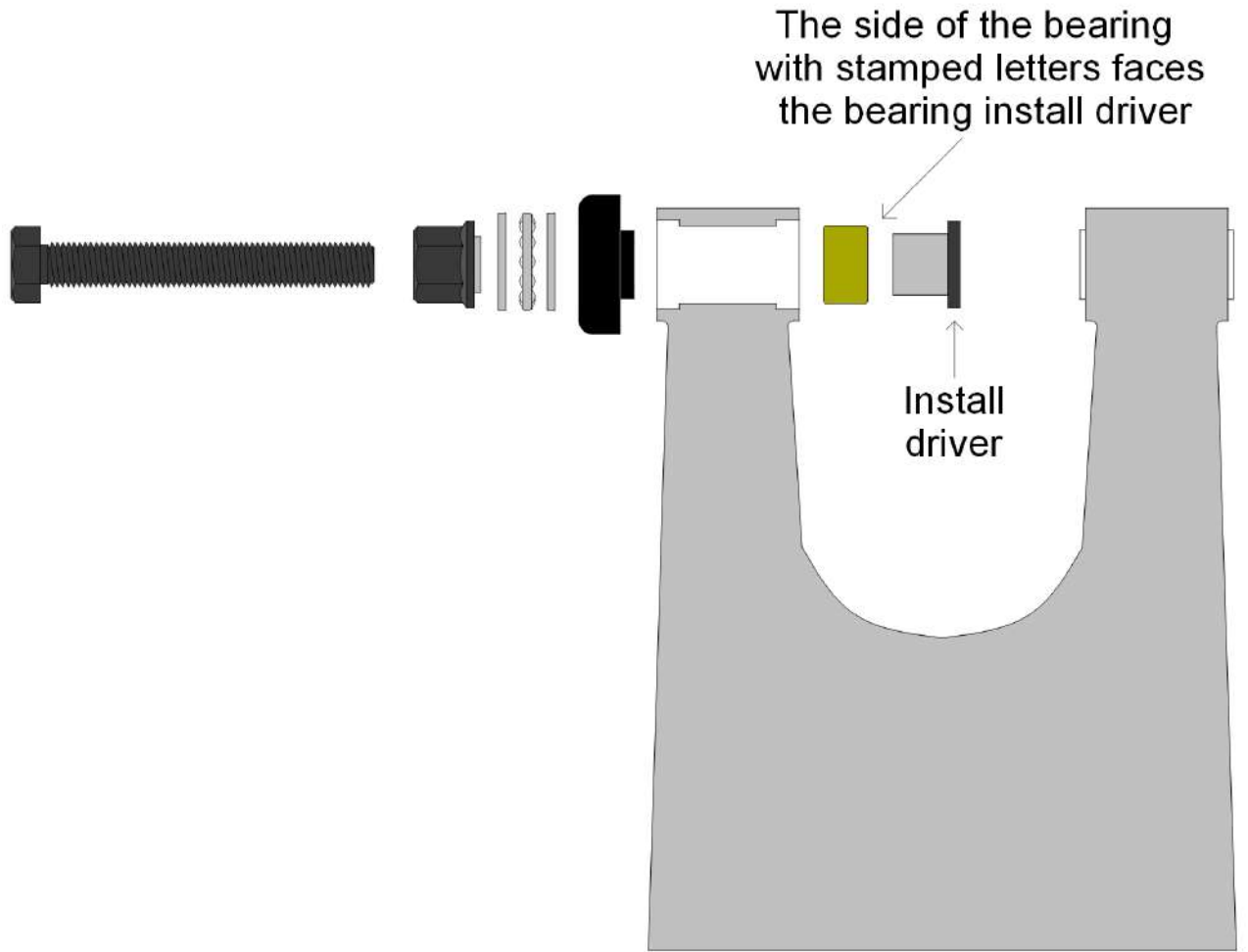

Set up tool for 2nd bearing installation  
(Grease before installing)

The side of the bearing  
with stamped letters faces  
the bearing install driver

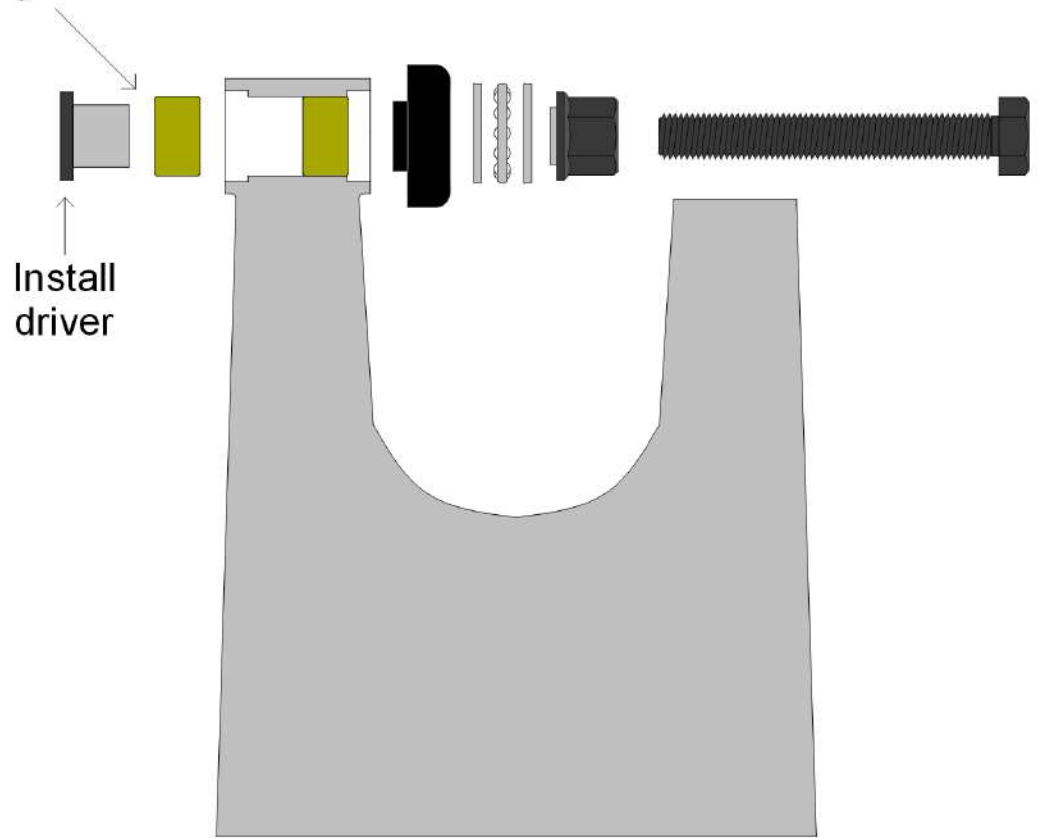

Hold bolt head still

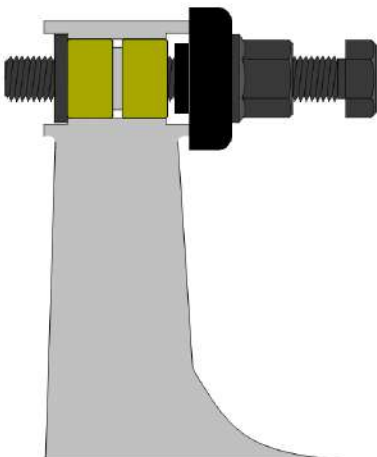
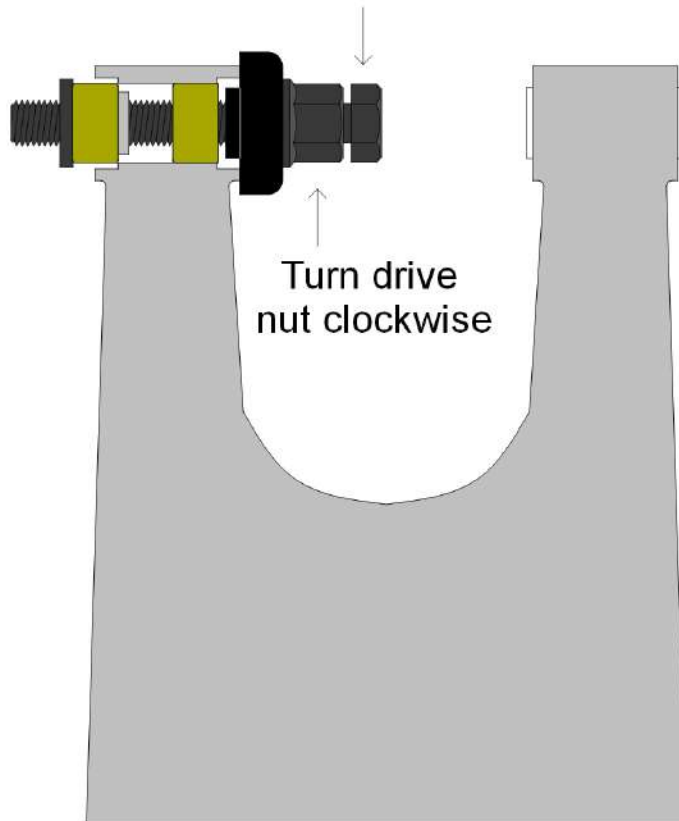

## Install stop discs

(These are installed in the chain side bearing housing as shown below)

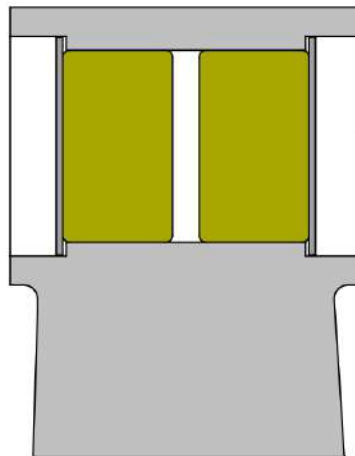
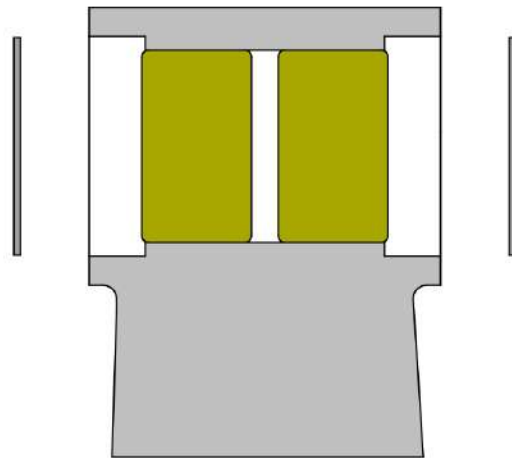

Pack bearings with grease

# Set up tool for 1st seal installation (Grease before installing)

Rubber face of seal seats  
against seal driver

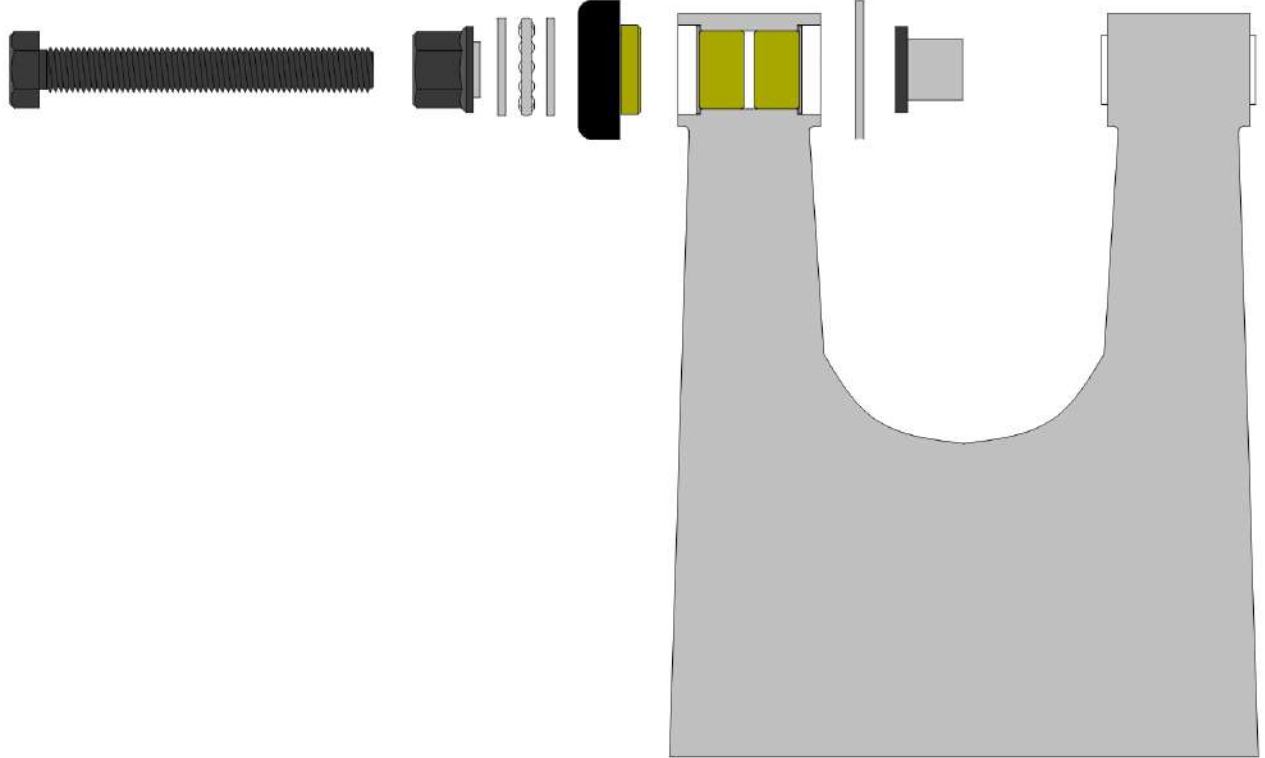

Hold bolt head still

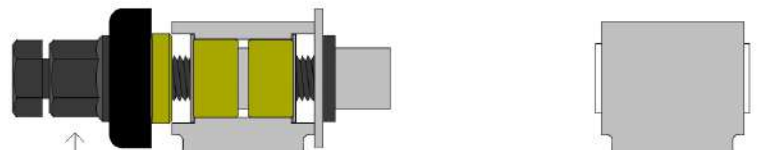

Turn drive nut clockwise

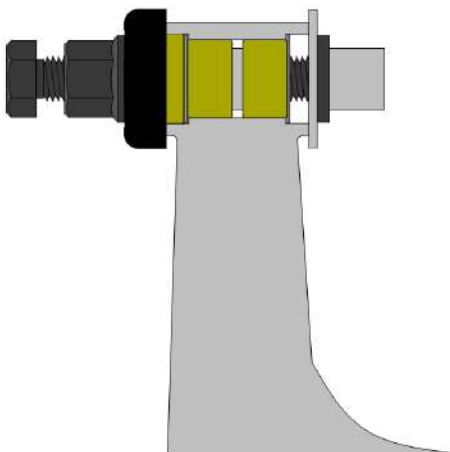

# Set up tool for 2nd seal installation

Rubber face of seal seats against seal driver

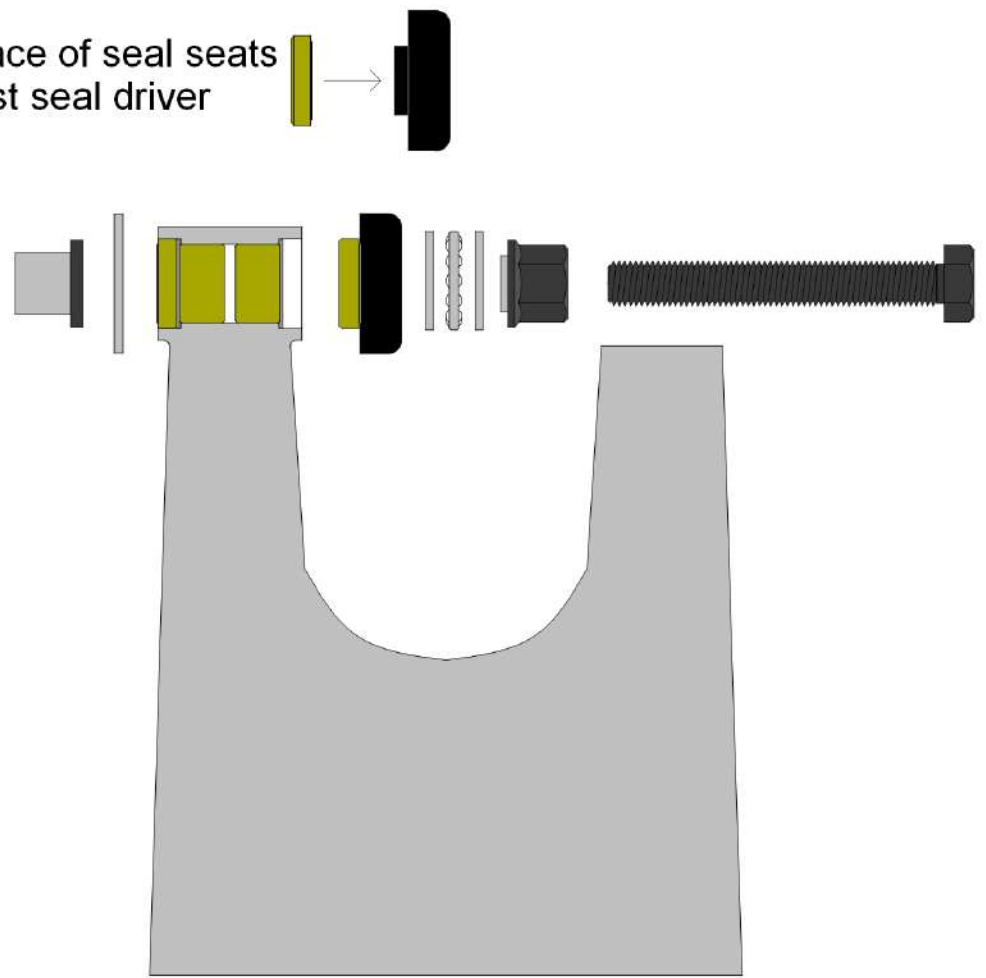

Hold bolt head still

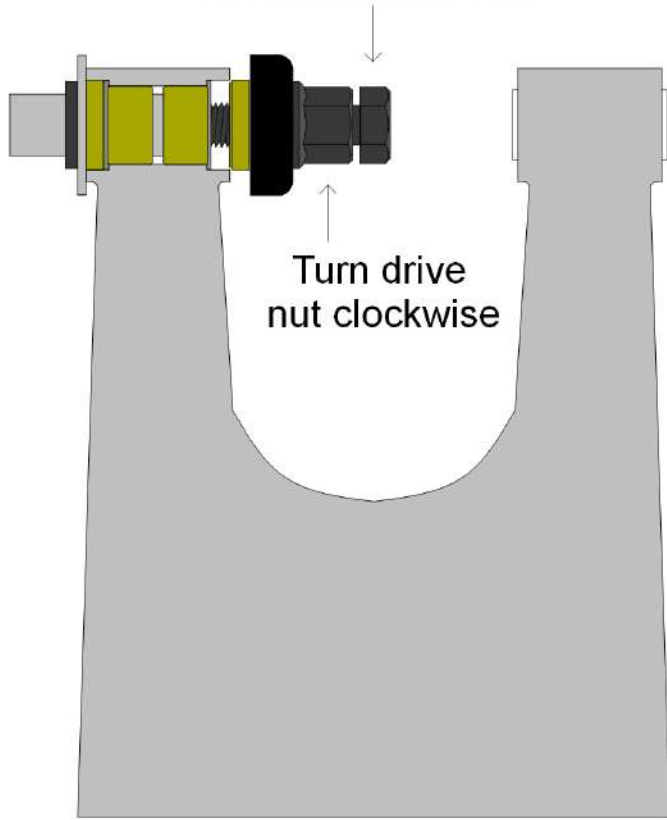

Turn drive nut clockwise

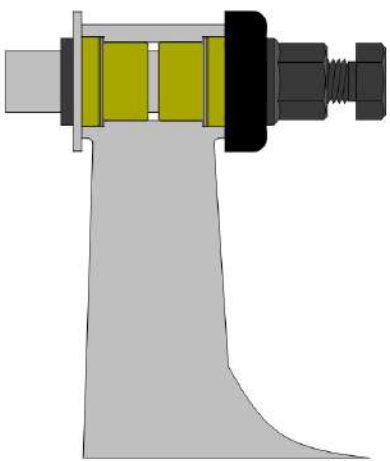

Install bearing sleeve and seal buckets  
(Grease before installing)

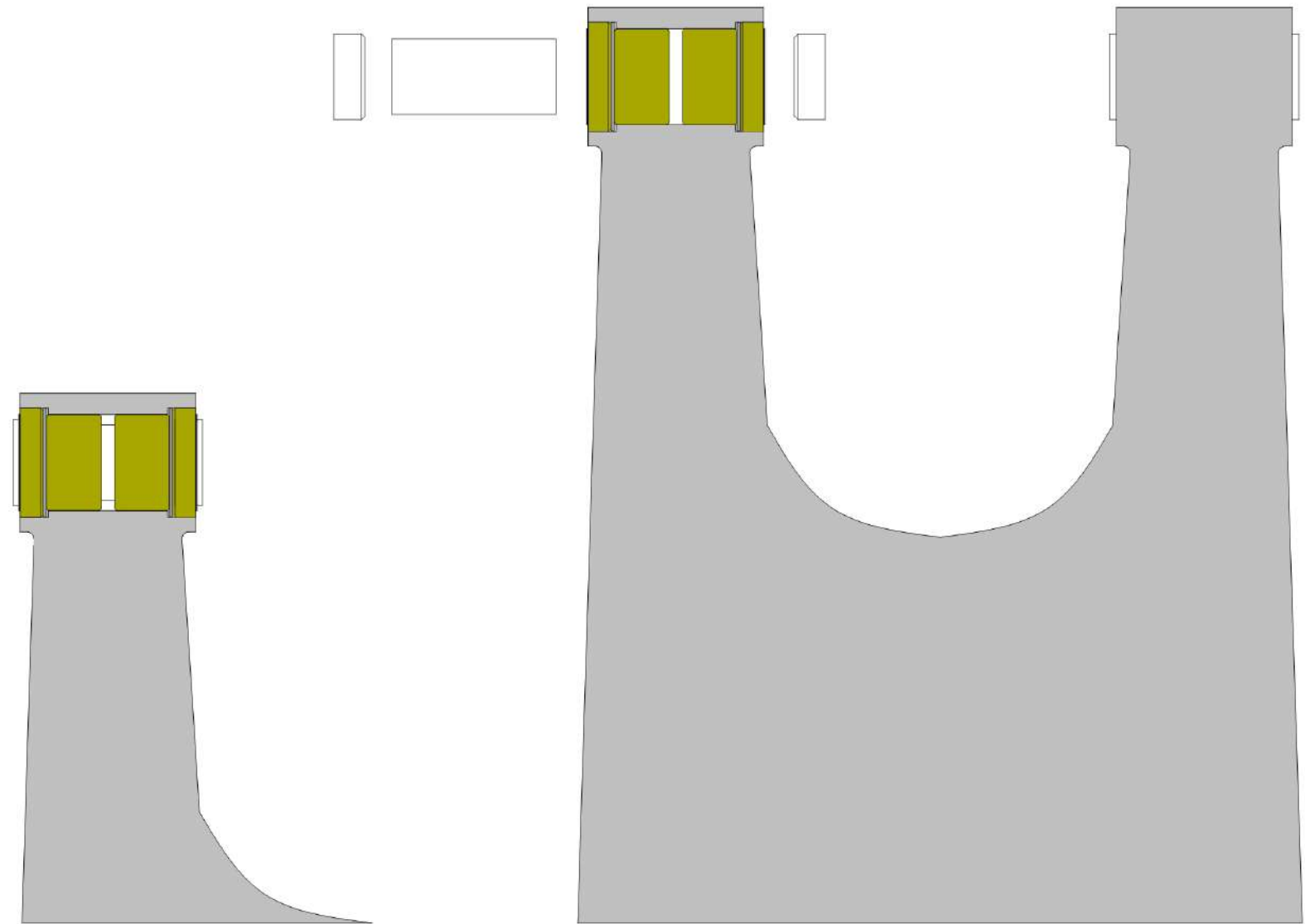

Use the same procedures to replace the bearings in the other side of the swingarm

**IMPORTANT**

It is vital you remove the stop discs before trying to remove the bearings.

The stop discs are usually installed in the chain side bearing housing of the swingarm, but not always.

Be sure to check for stop discs before removing bearings from both non chain side and chain side bearing housings of swingarm.

When installing new stop discs, its best practice to install them in the chain side bearing housing as they were when they left the factory. However if you forget don't worry.

They can be installed non chain side instead.

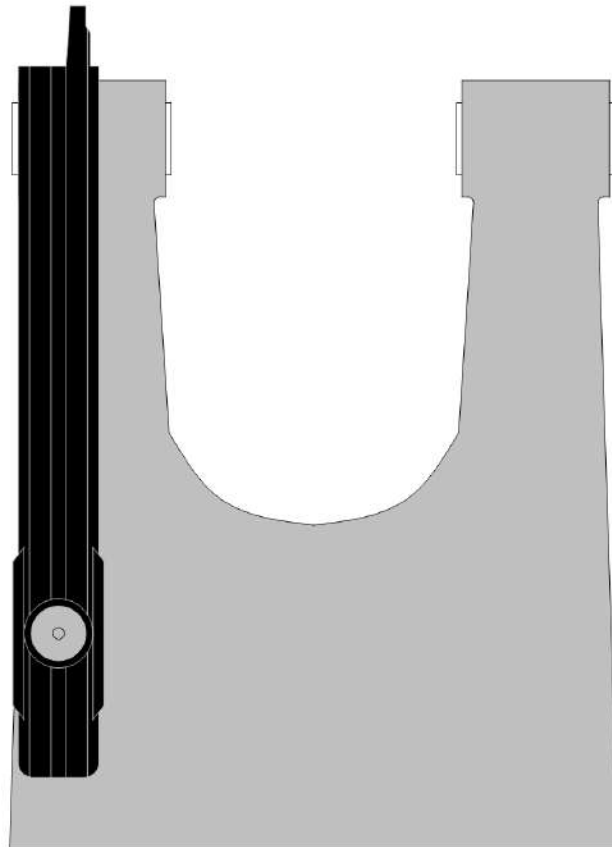

When you have finished replacing all the bearings and seals etc, you will find that there will be some play in the sideways movement of the bearing sleeve on the non chain side. This is normal. There should **not** be any play in the chain side bearing sleeve. The bearings may also seem stiff to move. This is normal. They will bed in and free up once bike is ridden.

